

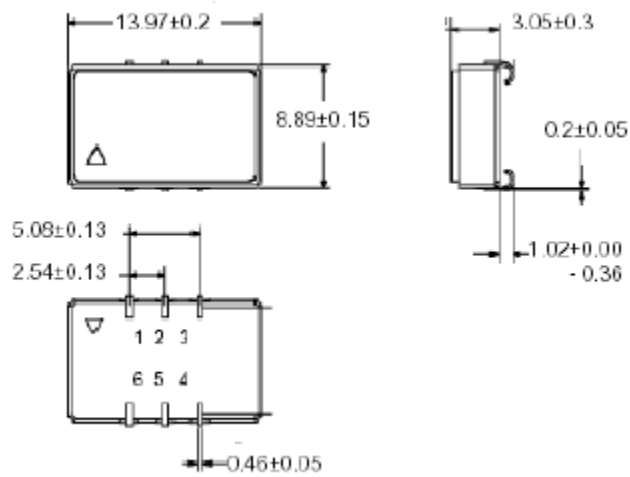

VCJ5

Package:	14.0 x 8.9 x 4.5 mm 6 pin J-lead Ceramic SMD
Frequency Range:	19.44 to 212.5 MHz
Supply Voltage:	Q = 3.3 Vdc \pm 5 % PECL
Electrical Option:	A = Complimentary Output, Enable/Disable (Pin2), 55/45 Symmetry B = Complimentary Output, Enable/Disable (Pin2), 60/40 Symmetry C = Complimentary Output, Enable/Disable (Pin1), 55/45 Symmetry D = Complimentary Output, Enable/Disable (Pin1), 60/40 Symmetry
Stability:	A = \pm 100 ppm 0°C to +70°C B = \pm 50 ppm 0°C to +70°C C = \pm 100 ppm -40°C to +85°C D = \pm 50 ppm -40°C to +85°C E = \pm 25 ppm 0°C to +70°C
Output Level "1":	Vcc – 1.025 V minimum
"0":	Vcc – 1.620 V maximum
Rise/ Fall Time:	2 nsec max. (20 % to 80 % of waveform)
Jitter:	6 psec RMS max., full bandwidth 1 psec RMS max., (12 KHz – 20 MHz)
Load:	50 ohms into Vcc – 2V
Current:	65 mA max.
STD Package:	Tape & Reel (200 pc)
Typical P/N:	VCJ5-QAB-156M25 J5 = 14.0 x 8.9 x 4.5 mm 6 pin J-lead Ceramic SMD Q = 3.3 Vdc \pm 5 % PECL A = Complimentary Output, Enable/Disable (Pin2), 55/45 Symmetry B = \pm 50 ppm 0°C to +70°C



Pin1: N/C or E/D*, Pin2: E/D or N/C*, Pin3: Ground
 Pin4: Output, Pin5: Complimentary Output, Pin6: Vcc

*Please refer to Electrical Options.